

## 30-320 Removing and installing, adjusting firewall accelerator control shaft

### A. Model 107

Preceding work:

Removing accelerator pedal ..... 30-330

Removing heater box ..... 83-100

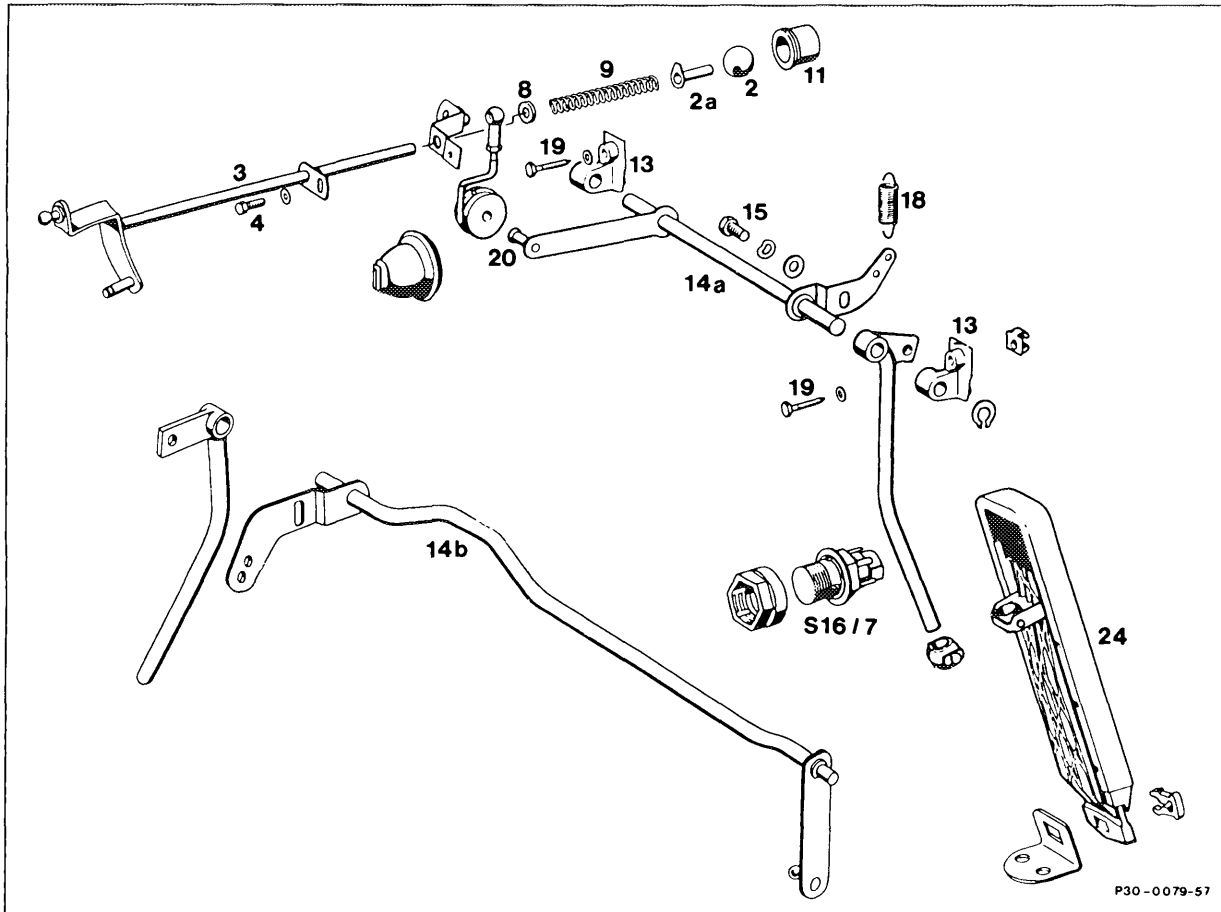

Connecting link with damping ring (20) .....	press off lever of accelerator control shaft (14a) (14b, not used), press on.
Return spring (18) .....	detach, attach in top hole.
Fastening bolts (19) .....	unscrew, screw on.
Plastic bearing (13) .....	press out up the way and take off accelerator control shaft with bearing.
Bearing points and ball sockets .....	grease with Molykote-Longterm 2.

Accelerator pedal (24) . . . . . depress as far as stop on kickdown switch (S16/7). When doing this, the throttle valve lever must be resting against full throttle stop. If necessary, correct setting by slackening screw (4).

If this setting does not produce full throttle or idle stop, adjust linkage rod (20) of longitudinal control shaft (14a) to length of 105 mm, measured from center of ball socket to center of damping ring.

As a check, slowly allow accelerator pedal to move back into idle position. In this position, the roller in the fulcrum lever must be resting free of tension against end stop.

If the setting described above does not produce full throttle or idle stop, slacken hex. bolt (15) in interior of car, press accelerator control linkage up to full throttle stop on throttle valve assembly and retighten hex. bolt.

## B. Model 126

Preceding work:  
 Removing accelerator pedal ..... 30-330

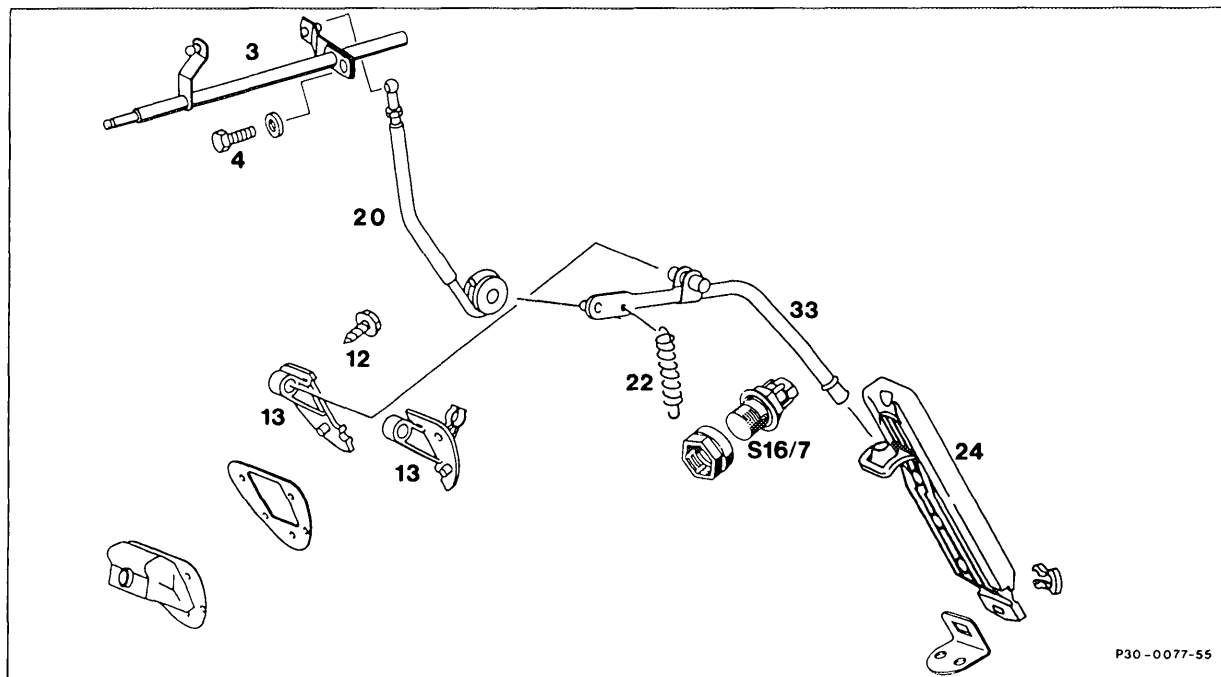

P30-0077-55

### Model 126

- |  |  |
|--|--|
| Return spring (22) .....                       | detach and attach.                               |
| Connecting link (20) .....                     | pull off accelerator pedal lever (33), press on. |
| Fastening bolts (12) .....                     | unscrew, screw in.                               |
| Bearing (13) with accelerator pedal lever (33) | remove.  |

### Installation

Grease bearing points and ball sockets with Molykote- Longterm 2.

- |                              |  |
|------------------------------|--|
| Accelerator pedal (24) ..... | depress as far as the stop on kickdown switch (S16/7). When doing this, the throttle valve lever must be resting against full throttle stop. If necessary, correct setting by slackening the bolt (4). If this setting does not produce full throttle or idle stop, proceed as follows:<br>Adjust connecting link (20) from longitudinal accelerator control shaft (3) to accelerator pedal lever (33) to a length of 220 mm, measured from center of ball socket to center of damping ring. |
|------------------------------|--|